

- Note:
1. Overlay board material: Steel.
  2. Arch material: Molded Polyurethane
  3. Overlay board width: 4 inches.
  4. Customer responsible to verify all field dimensions.

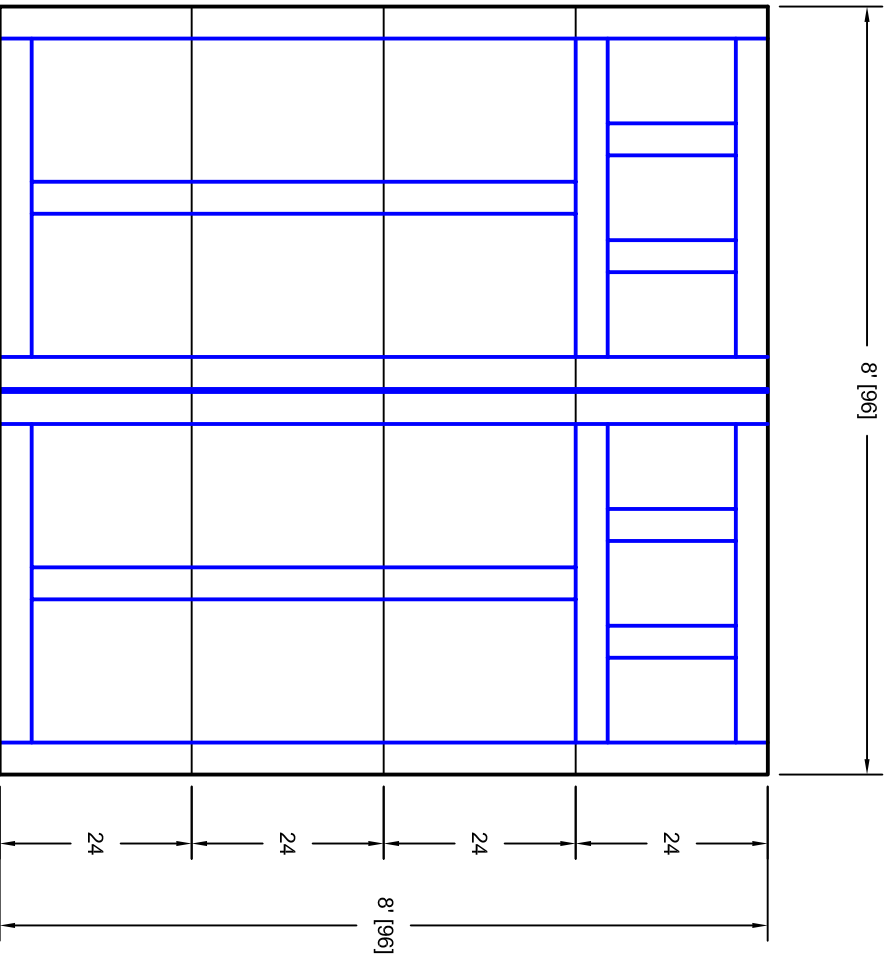

CUSTOMER APPROVAL REQUIRED FOR  
MANUFACTURING

X \_\_\_\_\_

DRAWN BY	E Gebhard 12-14-05	TITLE	Sage Creek w / Colonial Solid Top	
CHECKED			S16 8' X 8'	
DATE		SIZE	A	REV
APPD		SCALE	7S088016	A
DATE		WT. ACT.		SHEET
APPD				
DATE				

Unless Otherwise Specified Dimensions are in Inches	Tolerance on	Angles
Fractions	Decimals	
+/- 1/16	XX +/- .03	+/- 0.5
	XXX +/- .01	
	XXXX +/- .005	

<b>1ST</b> UNITED DOOR TECHNOLOGIES	7255 S. KYRENE SUITE #104
<b>UDT</b>	TEMPE, AZ 85283
	480-705-6632
	480-705-8497 fax
	www.firstudt.com